

# STATIC TORQUE SENSORS

- Wide range of applications: for testing electric, pneumatic and manual torque screwdrivers and torque wrenches and other torque tools and torque monitoring
- Clockwise and counter-clockwise operation
- High overall accuracy, good long-term stability

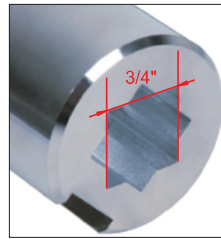

IST-NJ200L

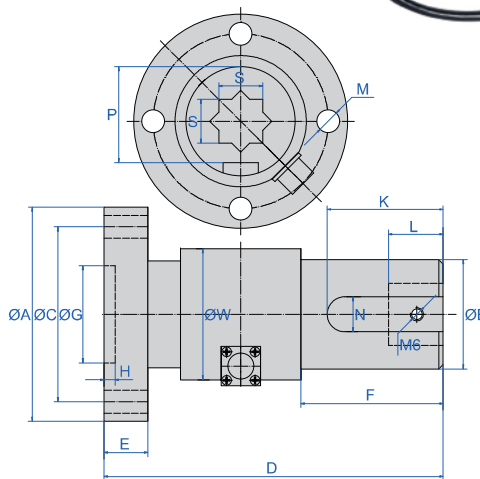
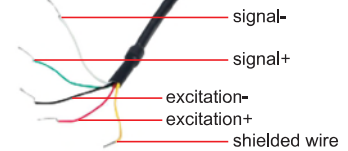

dimension drawing

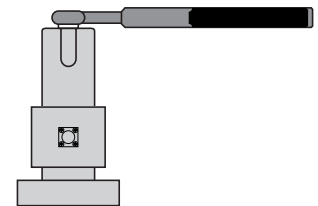

application

## SPECIFICATION

<b>Output sensitivity</b>	1.0~2.0mV/V
<b>Zero output</b>	±1%F.S.
<b>Linearity</b>	±0.1%F.S.
<b>Hysteresis</b>	±0.5%F.S.
<b>Repeatability</b>	±0.3%F.S.
<b>Creep (30 minutes)</b>	±0.1%F.S.
<b>Temperature sensitivity drift</b>	±0.1%F.S./10°C
<b>Zero temperature drift</b>	±0.1%F.S./10°C
<b>Response frequency</b>	10kHz
<b>Material</b>	Alloy steel / Stainless steel
<b>Electrical impedance</b>	350±5/700±5Ω
<b>Insulation impedance</b>	≥5000MΩ/100VDC
<b>Operating voltage</b>	5~15V
<b>Working temperature</b>	-20~80°C
<b>Safety overload</b>	120%
<b>Extreme overload</b>	150%
<b>Cable specification</b>	Ø5mm×3m
<b>Extreme cable pulling force</b>	10kg

(mm)

Code	Maximum range	A	B	C	W	D	E	F	K	L	N	S	P	M	G	H
IST-NJ10S	10N.m	98	50	80	58	90	15	33	33	25	16	20	44	4×Ø10.5 (4×Ø6 is optional)	/	/
IST-NJ20S	20N.m															
IST-NJ30S	30N.m															
IST-NJ50S	50N.m															
IST-NJ100S	100N.m															
IST-NJ200S	200N.m															
IST-NJ300S	300N.m															
IST-NJ500S	500N.m															
IST-NJ1000S	1000N.m															
IST-NJ10L	10N.m															
IST-NJ20L	20N.m															
IST-NJ30L	30N.m															
IST-NJ50L	50N.m															
IST-NJ100L	100N.m															
IST-NJ200L	200N.m															
IST-NJ300L	300N.m															
IST-NJ500L	500N.m															
IST-NJ1000L	1000N.m															
IST-NJ2000	2000N.m	125	75	105	83	150	20	65	60	30	20	25.5	67.5	8×Ø12	60	6
IST-NJ3000	3000N.m	125	75	105	83	150	20	65	60	30	20	40.5	67.5	8×Ø12	60	6
IST-NJ5000	5000N.m	125	75	105	83	150	20	65	60	30	20	40.5	67.5	8×Ø12	60	6

## STANDARD DELIVERY

Torque sensor (with connecting cable)	1 pc
---------------------------------------	------

## OPTIONAL ACCESSORY

Handheld force/torque indicators	ISF-DG series
----------------------------------	---------------